

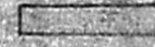

PLAN SHOWING THE PROPOSED CONSTRUCTION OF A RESIDENTIAL BUILDING IN S.No. 43/6A/11A/1A, PLOT No. 9B, RANGASWAMY STREET, HASNAPURAM VILLAGE, CHROMEPET, MADRAS-600044.

IN PALLAVARAM MUNICIPALITY
OWNER: A. HAKKARAPANI CHETTIAR.

SCALE: 1 INCH TO 8 FEET / 1:100

COLOUR REFERENCE
PROPOSALS ARE SHOWN THUS 
ROADS ARE SHOWN THUS 
BOUNDARY LINE SHOWN THUS 

AREA PARTICULARS

| | |
|------------------------|---------------------------|
| PLOT AREA | 204.39 sq.m (200 sq.ft.) |
| PRO. GROUND FLOOR AREA | 105.72 sq.m (1138 sq.ft.) |
| PRO. FIRST FLOOR AREA | 105.72 sq.m (1138 sq.ft.) |

SCHEDULE OF JOINERY

| | | | |
|----|------------|-------------|---------------|
| D | DOOR | 1.00 X 2.13 | (3'3" X 7'0") |
| D1 | DOOR | 1.91 X 1.98 | (3'0" X 6'6") |
| D2 | DOOR | .76 X 1.98 | (2'6" X 6'6") |
| W | WINDOW | 1.22 X 1.37 | (4'0" X 4'6") |
| V | VENTILATOR | .91 X .61 | (3'0" X 2'0") |

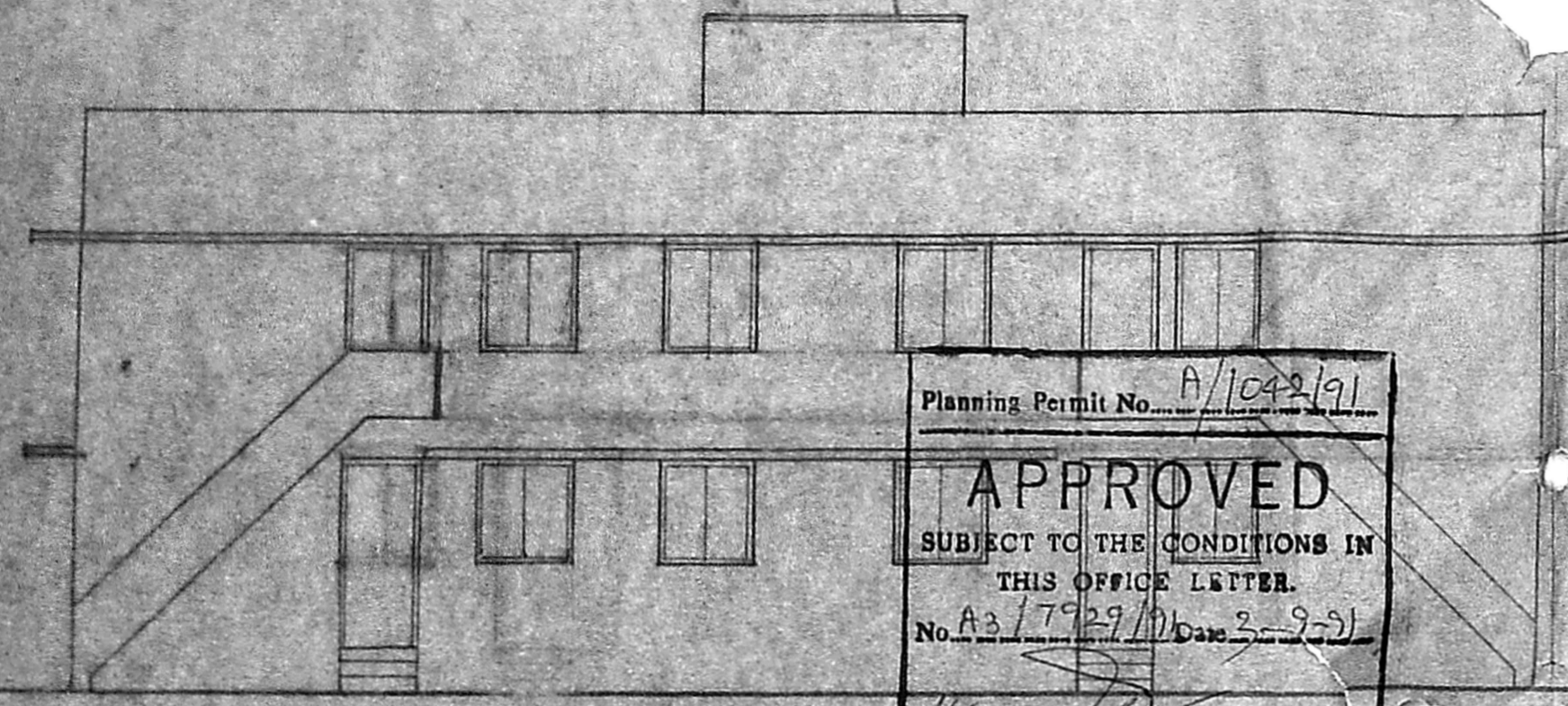

WEST SIDE ELEVATION

Planning Permit No. A/1042/91
APPROVED
SUBJECT TO THE CONDITIONS IN THIS OFFICE LETTER.
No. A3/7929/11 Date 3-9-79
FOR MEMBER SECRETARY
MADRAS METROPOLITAN DEVELOPMENT AUTHORITY
MADRAS - 600 008

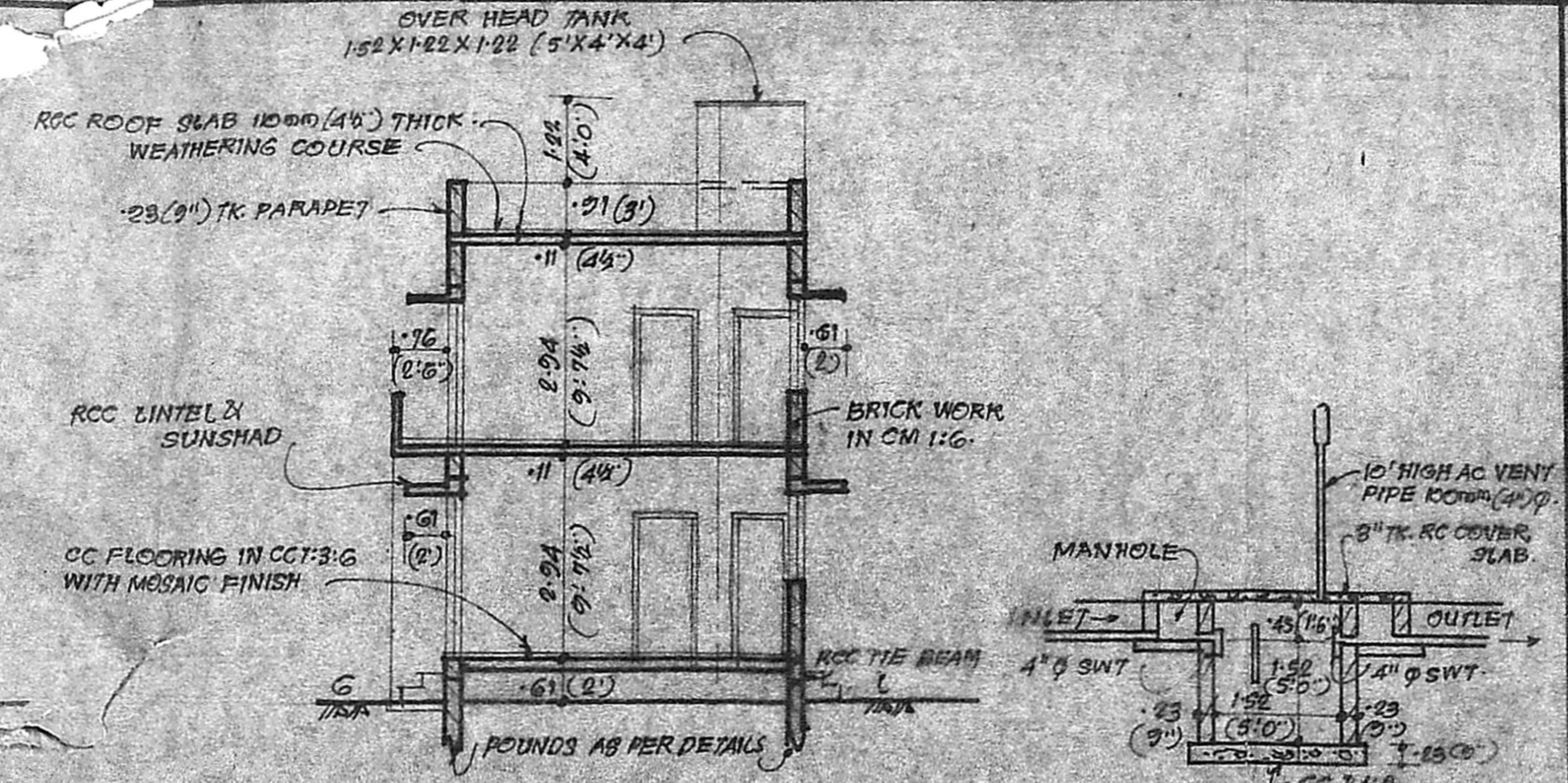

SECTION ON AB

SECTION OF SEPTIC TANK

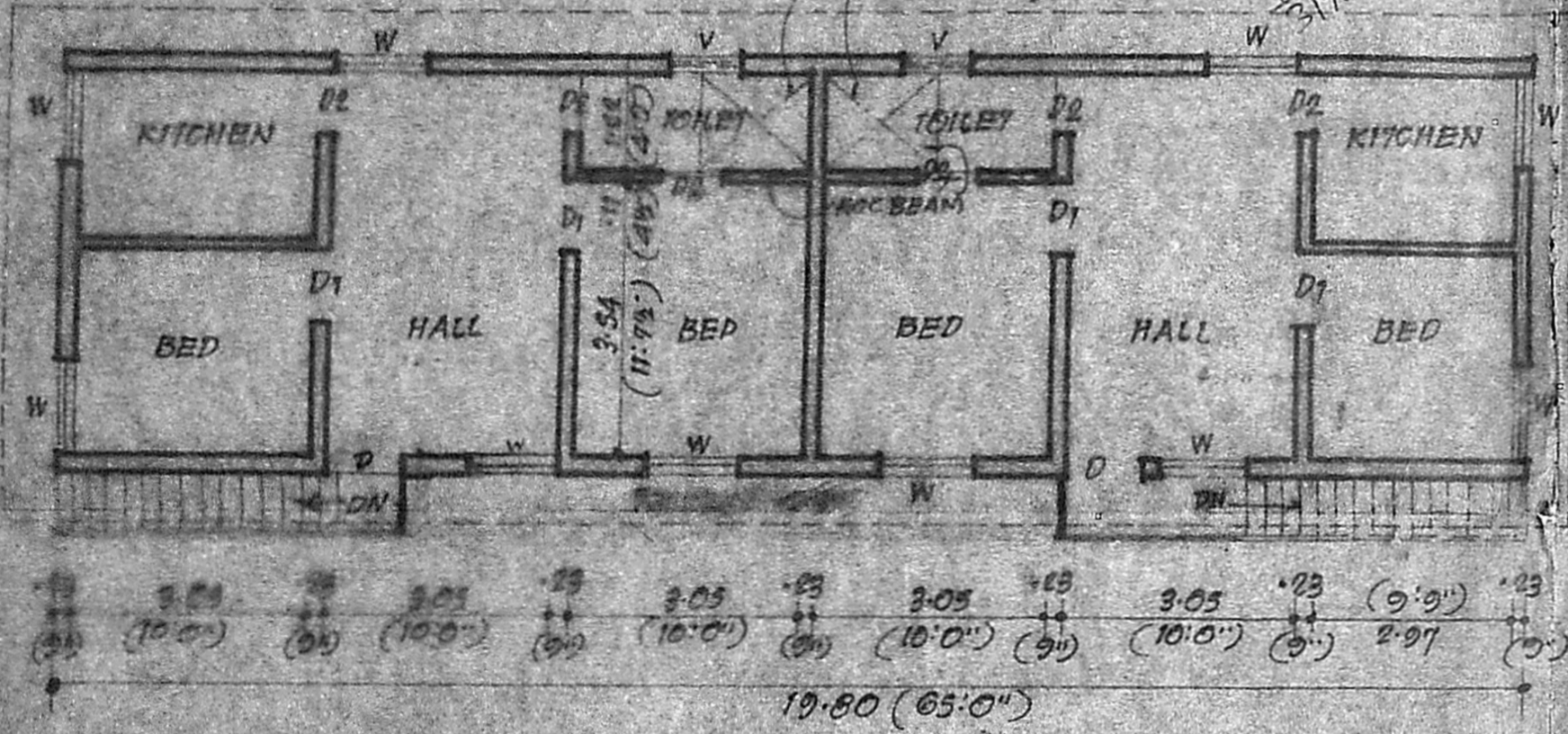

FIRST FLOOR PLAN

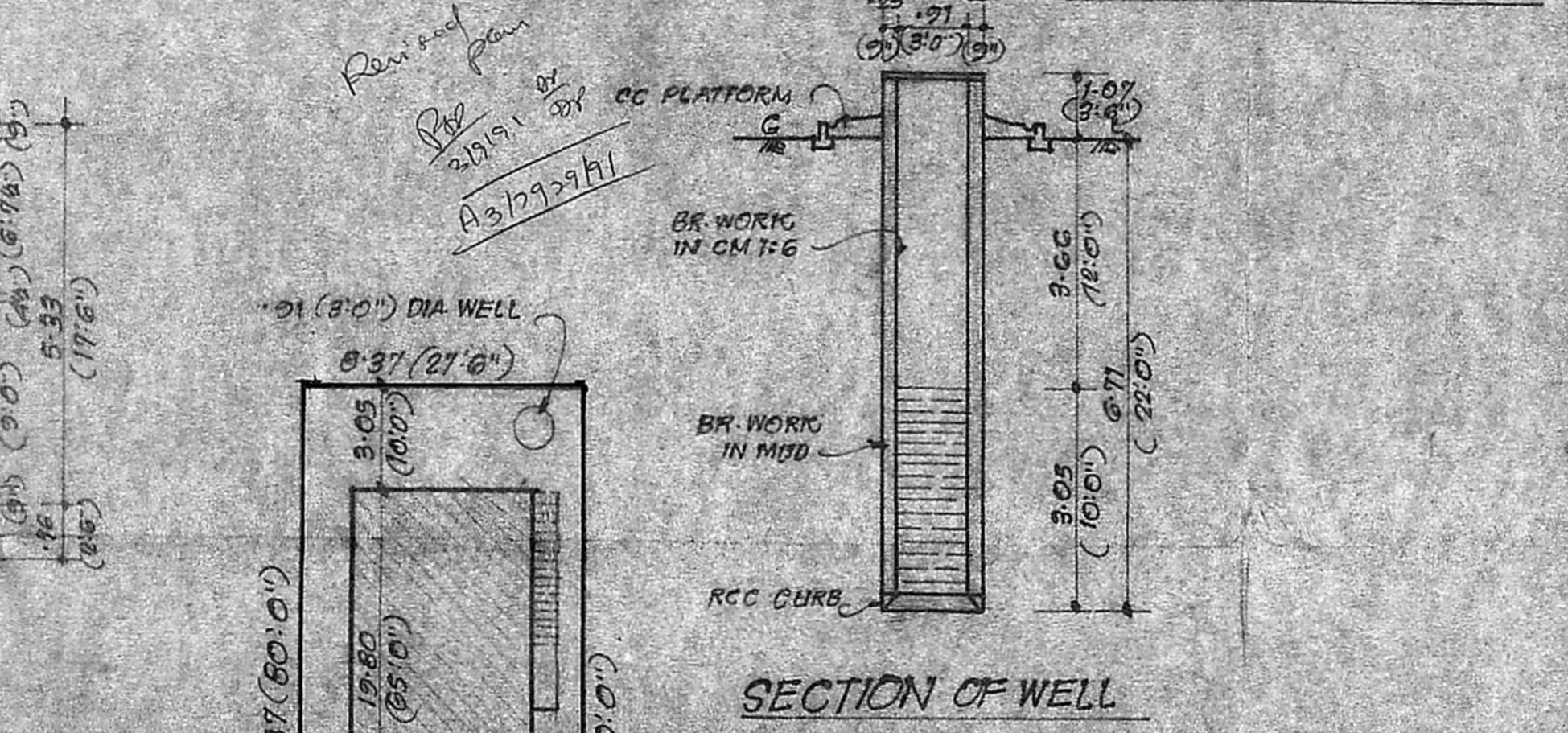

SECTION OF WELL

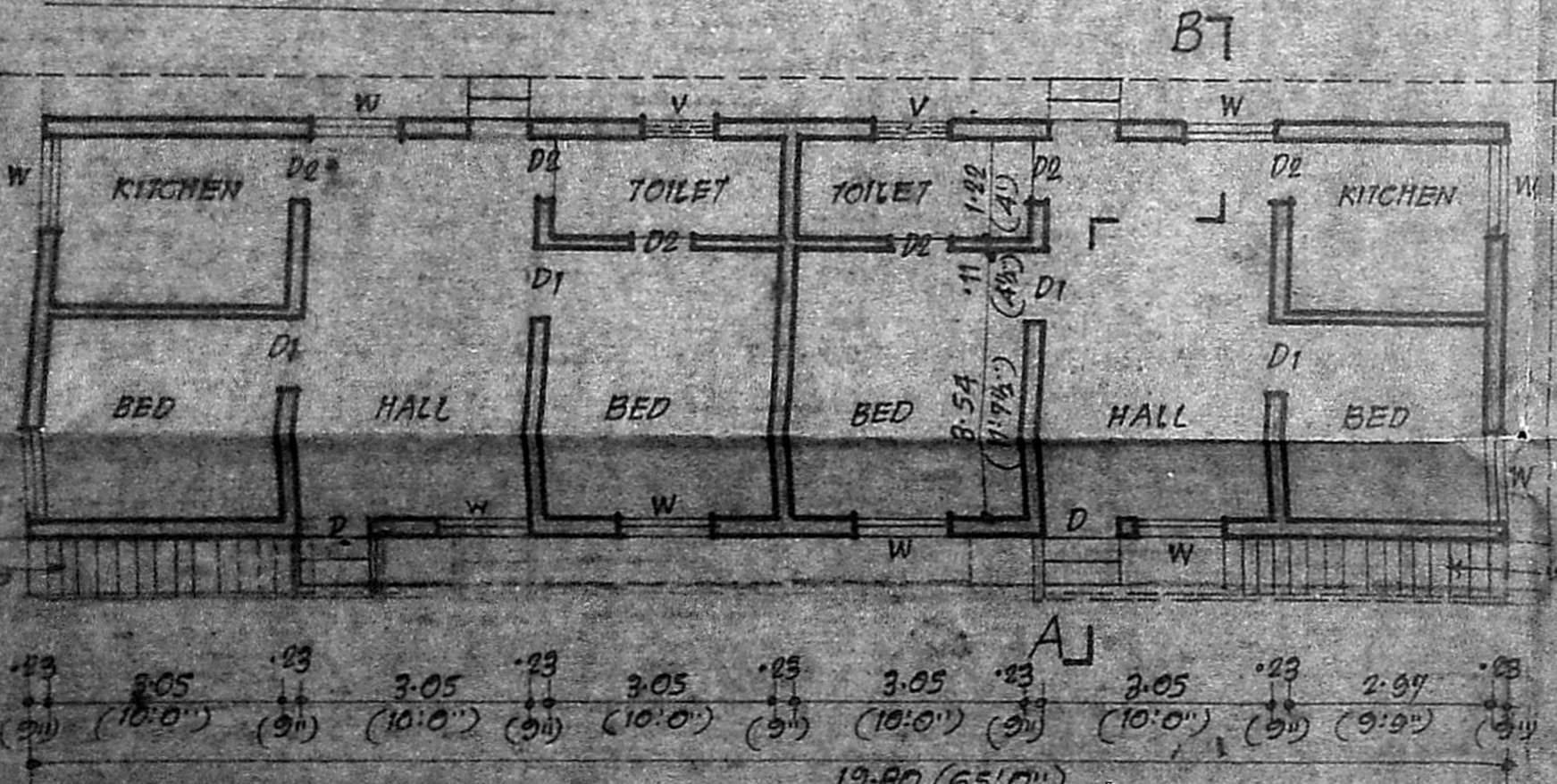

GROUND FLOOR PLAN

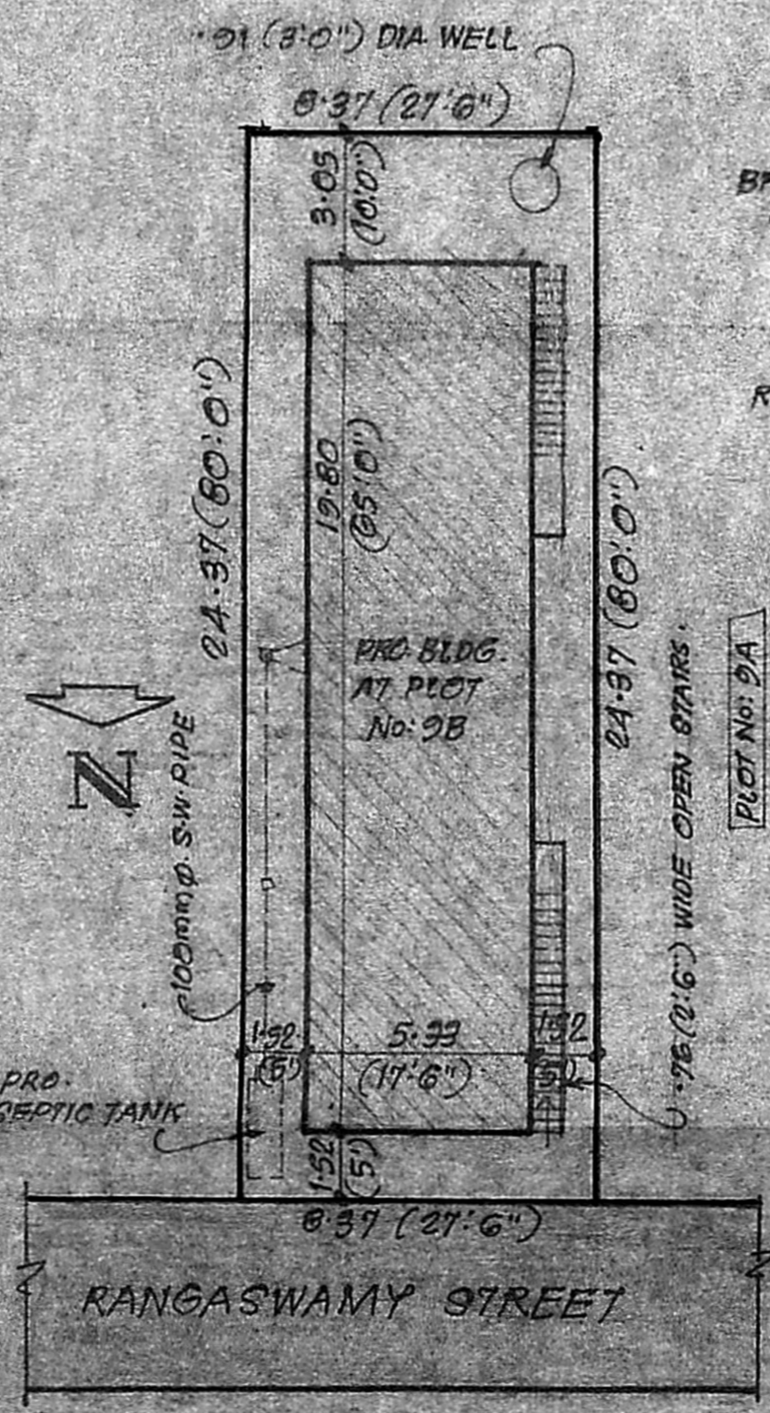

SITE PLAN

SCALE: 1:200 (1" = 16'0")

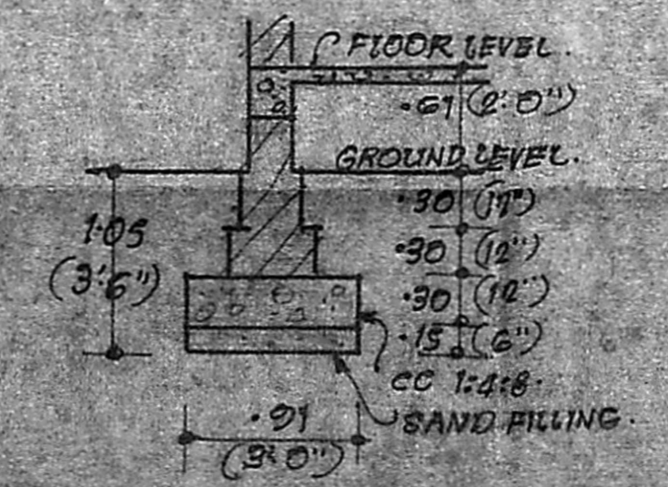

DETAILS OF FOUNDATION

(NOT TO SCALE)

T. G. Krishnamurthy Rao
T. G. KRISHNAMURTHY RAO,
Civil Engineer,
Class I Licensed Surveyor No. 370,
CORPORATION OF MADRAS,
C-10, SANTHI AVENUE,
11/12, LAKE VIEW ROAD,
WEST MAMBALAM, MADRAS-600 033,
LICENSED SURVEYOR

OWNER